

Electric Vacuum Suction Cup



Read before use







INDEX

- ① Safety Warnings
- ② Application
- ③ Using Instructions
- ④ Cleaning and Maintenance
- ⑤ Accessories
- ⑥ Environmental Protection
- ⑦ Warranty

Symbols

The following are the icons that are used for the tool. Make sure you fully understand them before using them.

	Read before use
	CE mark
	Caution
	Conforms to WEEE

	Wear safety gloves
	Wear hearing protectors
	Wear safety glasses

1. Safety Warnings

⚠ Caution

Read all safety instructions and warnings provided. Failure to follow the instructions below may result in serious injury. Keep all warnings and instructions for future reference.

Safety warnings from the manufacturer

- Ensure surface of to be lifted material is dry and clean.
- Check vacuum cups for damage or perishing or glazing.
- NEVER use the lifer to support a person.
- NEVER attach ropes or chains directly to handle. Lifter is for hand lifting tasks only.
- NEVER touch the thumb release plate during lifting.
- Use within range: 0 to 45 °C (32°F to 113°F)
- Use below 1524 metre (5000 feet) elevation.

If there is any question about a condition being safe or unsafe. **DO NOT** use the product.

Use and care of the battery tool

- a) **Charge the batteries only with chargers recommended by the manufacturer.** A charger suitable for a particular type of battery may cause a fire when used with other batteries.
- b) **Use only the appropriate batteries in the power tools.** Use of other batteries may cause injury or fire.
- c) **Keep the unused battery away from paper clips, coins, keys, nails, screws, or other small metal objects that could cause the contacts to bridge.** A short circuit between the battery contacts can cause burns or fire.
- d) **If used incorrectly, liquid may leak from the battery. Avoid contact with it. In case of accidental contact, rinse with water. If the fluid gets into your eyes, seek additional medical attention.** Leaking battery fluid may cause skin irritation or burns.
- e) **Do not use a damaged or modified battery.** Damaged or altered batteries can behave unpredictably and cause fire, explosion or injury.
- f) **Do not expose a battery to fire or high temperatures.** Fire or temperatures over 130 ° C can cause an explosion.
- g) **Follow all charging instructions and never charge the battery or the cordless tool outside the temperature range specified in the operating instructions.** Incorrect charging or charging outside the permitted temperature range can destroy the battery and increase the risk of fire.

2. Application

- Powered by 21V lithium-ion battery
- Digital gauge showing pressure
- Smart sensor monitor maintains optimum suction
- Double layer pad for smooth surfaces
- Additional pad specifically for textured items
- Max. lifting capacity 170Kg(375lbs)

Battery voltage	21V, 2.0Ah Li-ion
Lifting capacity	170KG(375lbs)
Working temperature:	0 to 45 °C (32°F to 113°F)
Charge Input Voltage	100V-240V 50/60Hz
Full charging hours	2.5hours
Continuous working hours:	3hours

**Manufacturer reserves the right to change specifications without notice.
 Specifications may differ from country to country**

3. Using Instruction

- If the device is not used for a long period of time, please fully charge and remove the battery. Please store the battery in a dry and room temperature environment.
- If the lithium battery is not used for extended time, please charge the lithium battery once every 6 months, each charging time is not less than 6 hours.

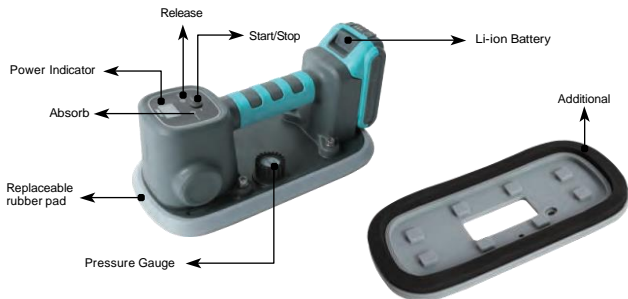

		
Silicone Rubber pad, suitable for smooth surface	Silicone Rubber pad, suitable for texture surface	Change a New Rubber

3.1 Press and hold the switch for 3-5 seconds to turn on and off the machine. After powering on, the digital tube is always red.

3.2 Press the switch once to inhale. The Absorbing LED light (Absorbing) will always be green. When the inhalation is completed, the LED light will go out.

Press the switch quickly 2 times to exhaust, the exhaust LED light (Releasing) is always green, the exhaust is completed, and the exhaust LED light goes out.

In the inhalation state, when the digital tube displays greater than 600, stop inhaling; when the digital tube displays less than 480, start replenishing air. It is 0.8bar when inhaling full air, and starts to refill when it is close to 0.64bar.

3.3 Self-consumption current IDD, internal consumption of the circuit when not working, is less than 100ua.

Sleep time, enter sleep after 30S of no action.

3.4 Over-discharge protection:

VDET1, over-discharge detection voltage, 13.5±0.5V

VREL1, over-discharge release voltage 15±0.5V

Short circuit protection

Short circuit protection current > 20A

Short circuit protection detection delay time < 1000us

3.5 Working temperature: 0 to 45°C (32°F to 113°F), humidity: MAX. 85%

3.6 Digital tube error code:

E01 triggers over-discharge protection

E02 triggers overcurrent protection

E03 triggers short circuit protection

E04 Air pressure sensor communication error

Charging instructions

- If the indicator turn into yellow or red, recharge the battery.

- The battery will be fully charged in 2.5 hours, at the end the indicator will turn green to indicate full charge (the red color indicates the charge in progress).

4. Cleaning and Maintenance

- The machine must be stored in dry place .

- Remove any dirt or dust from the surface of the machine after use.

- Store the machine in the carry case supplied to avoid damage.

- During frequent use it is recommended to recharge the battery daily.

- Check the screws are well fixed, loose screws may cause injury

- NEVER use solvent to clean suction cup; NEVER use oil based lubricants.

5. Accessories

- Original battery is recommended for use with vacuum suction cup

- Using other accessories or attachments may result in personal injury.

- Only use original accessories or accessories for the stated purpose.

6. Environmental Protection

- Do not dispose of electrical appliances in the household waste.

- Follow the local provisions for the disposal of electrical or battery products.

- Valuable materials can be recovered by recycling.

- The electrical or battery components used for construction are in accordance with the regulation European Directive 2012/19 / EU on waste electrical and electronic equipment and transposition into national law., used electrical appliances must be collected separately and recycled in an environmentally sound manner.

- Contact us for further information.



7. Warranty

- The guarantee covers all manufacturing or assembly defects in accordance with the legislation in force. The guarantee does not cover malfunctions caused by improper use, overloads, failure to follow the operating instructions and normal wear and tear.

- For more details and information, consult the general guarantee conditions at www.bihuitools.com